

FLOOD DAMAGE REPAIRS
FOR THE
AUDENREID MINE TUNNEL
ABANDONED MINE DRAINAGE REMEDIATION PROJECT
LOCATED IN
EAST UNION TOWNSHIP,
SCHUYLKILL COUNTY, PA

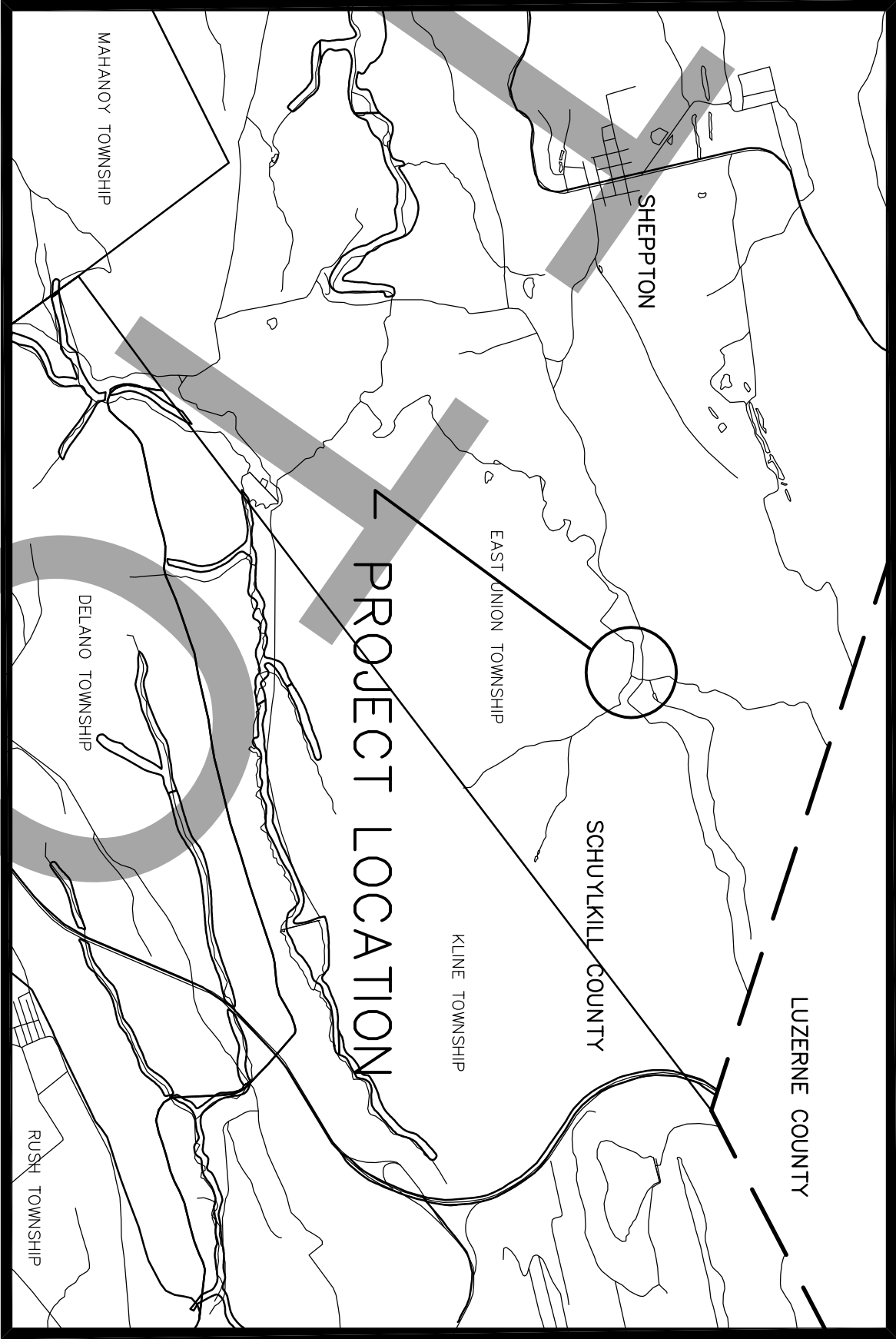

LOCATION MAP
APPROXIMATE SCALE: 1"=4000'

GENERAL NOTES

1. BENCHMARK-- TRAVELER POINT "R"-10 LOCATED APPROXIMATELY 460' SOUTHWEST OF PAUL ROAD CULVERT. ELEVATION 124.50' DATUM: NAD 83. ELEVATION: 1191.15' DATUM: NAVD83.
2. ALL EXISTING UTILITIES HAVE BEEN SHOWN IN ACCORDANCE WITH THE BEST AVAILABLE INFORMATION.
3. THE CONTRACTOR SHALL DETERMINE THE EXACT LOCATION OF ALL ABOVE GROUND AND BELOW GROUND UTILITIES AND STRUCTURES AND WILL BE RESPONSIBLE FOR THE PROTECTION OF THESE UTILITIES AND STRUCTURES AT ALL TIMES.
4. THE EXISTING UTILITIES AND STRUCTURES SHALL BE PROTECTED TO PREVENT DAMAGE. THE CONTRACTOR SHALL TAKE ALL NECESSARY PRECAUTIONS TO PROTECT THE EXISTING UTILITIES AND STRUCTURES AND COMPLETELY AT HIS EXPENSE.
5. THE PLAN LOCATIONS AND DIMENSIONS SHALL BE STRICTLY ADHERED TO THROUGHOUT THE PROJECT. ANY DEVIATIONS SHALL BE SUBJECT TO THE APPROVAL OF THE ENGINEER.
6. CONTRACTOR SHALL BE RESPONSIBLE FOR MAINTAINING A COPY OF ALL PERMITS RELATED TO THE CONSTRUCTION SHOWN ON THESE PLANS ON THE JOB SITE AT ALL TIMES.
7. THE CONTRACTOR SHALL VERIFY ALL DIMENSIONS ON THE PROJECT SITE.
8. CONTRACTOR SHALL VERIFY UTILITIES REQUIRED PER LOT 147 FOR VERIFICATION AND LOCATION OF UTILITIES PRIOR TO CONSTRUCTION.
9. THE CONTRACTOR SHALL BE RESPONSIBLE FOR ALL JOB SITE SAFETY INCLUDING: ALL TRAFFIC CONTROL, TRENCH BARRICADING, COVERING, SHIELDING AND SHORING.
10. ALL BEAMS AND IMPONEMENTS SHALL BE CONSTRUCTED IN 8" LIFTS AND COMPACTED TO 95% PROCTOR DENSITY.
11. THE CONTRACTOR SHALL BE RESPONSIBLE FOR COORDINATING ACCESS TO ADJACENT PROPERTIES, LP AND & GUN CLUB, PCA CORPORATION, AND GLASTONE PARTNERS, LP.
12. ALL NON-CALCULATEDS AGGREGATE UTILIZED ON SITE SHALL MEET SPECIFICATION SET FORTH IN PERMITS PUBLICATION 449/2003. CERTIFICATION WILL BE REQUIRED FOR QUALITY AND CLASSIFICATION OF ALL AGGREGATE UTILIZED.
13. THE CONTRACTOR SHALL BE RESPONSIBLE FOR THE REMOVAL AND DISPOSAL FOR ALL UNUTILIZED MATERIAL ON THE SITE.
14. ALL CLAY MATERIAL SHALL BE COMPACTED TO ELIMINATE SEEPAGE.
15. MATERIAL FOR CONSTRUCTION OF BEAMS SHALL BE CLEAN, FILL FREE OF DEBRIS, AND SHALL BE PLACED IN LIFTS. IT IS THE CONTRACTOR'S RESPONSIBILITY TO REPAIR ANY DAMAGE CAUSED BY SUCH EQUIPMENT.
16. TRENCH EQUIPMENT SHALL BE PLACED ON THE EXISTING PAVEMENT.
17. THE CONTRACTOR SHALL BE RESPONSIBLE FOR NOTIFYING BLUE NOB ROD & GUN CLUB, PCA CORPORATION, GLASTONE PARTNERS, LP, RETTEW ASSOCIATES, INC. AND SCHUYLKILL CONSERVATION DISTRICT PRIOR TO THE START OF CONSTRUCTION.

UTILITIES RESPONDED:

SHEPTON TOWNSHIP MUNICIPAL AUTHORITY
5725 VALLEY STREET
NEW PHILADELPHIA, PA. 179591218
CONTACT: MICHAEL E BURDA

PPL ELECTRIC UTILITIES CORPORATION
1600 MONROSVILLE BLVD
MONTROSVILLE, PA 17046301
CONTACT: THOMAS BOOTH

SINOCO PIPELINE, LP
SINOCO PIPELINE, LP
SINCO SPRING, PA 18608
CONTACT: ONE CALL DEPARTMENT

VERICON PENNSYLVANIA, INC
VERICON PENNSYLVANIA, INC
HARRISBURG, PA 17101
CONTACT: THERESA D BEATTY

PA1
SYSTEM, INC.
PENNSYLVANIA LAW REQUIRES
3 WORKING DAYS NOTICE FOR
CONSTRUCTION AND 10 WORKING
DAYS IN DESIGN STAGE - 5 DAY CALL

1-800-242-1776

AND RETTEW ASSOCIATES, INC. DOES NOT MAKE ANY REPRESENTATION, WARRANTY OR ASSURANCE THAT THE INFORMATION RECEIVED PURSUANT TO SAID REQUEST AND AS REFLECTED ON THESE DRAWINGS IS CORRECT OR ACCURATE, BUT RETTEW ASSOCIATES, INC. IS REFLECTING THE INFORMATION AS RECEIVED AND AS REFLECTED ON THESE DRAWINGS OF THE SAID ACT NO. 187 OF DECEMBER 19, 1996.

ONE CALL SYSTEM SERIAL NO. NOTIFICATION BY RETTEW ASSOCIATES, INC. DATE: 6/25/07

1. PURSUANT TO SECTION 4, CLAUSE (2) OF SAID ACT, RETTEW ASSOCIATES, INC. REQUESTED THAT THE INFORMATION RECEIVED ON SUCH LIST PROVIDED BY THE ONE CALL SYSTEM NOTIFICATION, THE INFORMATION BE VERIFIED BY THE CONTRACTOR PRIOR TO THE FINAL DESIGN TO BE COMPLETED.
2. PURSUANT TO SECTION 4, CLAUSE (3) OF SAID ACT, RETTEW ASSOCIATES, INC. REQUESTED THAT THE INFORMATION RECEIVED WHERE EXCAVATION IS TO BE PERFORMED.
3. ASSOCIATES, INC. HAS SHOWN UPON THESE DRAWINGS "THE POSITION AND TYPE OF EACH LINE, AS DERIVED PURSUANT TO THE REQUEST BY THE CONTRACTOR, AS REQUIRED BY CLAUSE (2), THE SECOND CLAUSE OF THE PENNSYLVANIA ACT NO. 187 OF DECEMBER 19, 1996, THE USER'S DESIGNATED OFFICE ADDRESS AND PHONE NUMBER AS SHOWN ON THE SAID ACT" REFERRED TO IN SECTION 4, CLAUSE (3) OF SAID ACT.

SHEET INDEX	
SHT. 1	COVER
SHT. 2	TREATMENT AREA / MISCELLANEOUS REPAIRS
SHT. 3	TUNNEL AREA EXISTING CONDITIONS
SHT. 4	TUNNEL AREA REPAIR PLAN
SHT. 5	TUNNEL AREA PROFILE
SHT. 6	CULVERT DETAILS
SHT. 7	TUNNEL AREA REPAIR E&S PLAN
SHT. 8	DETAILS SHEET
SHT. 9	DETAILS SHEET
SHT. 10	DETAILS SHEET
SHT. 11	DETAILS SHEET

LEGEND:	EXISTING	PROPOSED
UTILITY LINE/POLE		
GAS LINE /GATE VALVE & BOX		
WATER LINE/HYD. VALVE		
SEWER LINE/MANHOLE		
LOW PRESSURE SEWER/FORCE MAIN		
STORM LINE/INLET/ENDWALL		
CORRIDOR		
ADJONERS/PROPERTY LINE		
UNDERGROUND ELECTRICAL		
OVERHEAD ELECTRICAL		
EASEMENT LINE		
RIGHT-OF-WAY LINE		
BOUNDARY LINE		
CENTERLINE		
EDGE OF PAVEMENT		
DRIVEWAY		
SILT FENCE		
FENCE		
WOODS LINE		
GUY WIRE		
TREE		
SHRUB		
MAIL BOX		
SIGN		

FLOOD DAMAGE REPAIRS
FOR THE
AUDENREID MINE TUNNEL
ABANDONED MINE DRAINAGE REMEDIATION PROJECT
COVER SHEET
EAST UNION TOWNSHIP SCHUYLKILL COUNTY, PA

RETTEW
RETTEW Associates, Inc.
950 E. Main Street, Suite #220
Schuylkill Haven, PA 17972
Phone (570) 385-2270 • Fax (570) 385-2217
Email: rettew@rettew.com Website: www.rettew.com

Engineers • Planners • Surveyors • Landscape Architects
Environmental Consultants

CLIENT

SCHUYLKILL CONSERVATION DISTRICT
1206 AG CENTER DRIVE
POTTSVILLE, PA 17901-9733

SCALE
AS NOTED

MANAGER: CLAYTON E. BUBECK, P.E.
DESIGN BY: CH
DRAWING REFERENCE: N:\06\06-03883-003\Cad\EE\06-03883-003-Cover.dwg
XREFS:

SURV. CHIEF:
CHKD BY: CEB
DRAWN BY: CH/SBT

FIELDBOOK NO. DATA COLLECTOR
CHKD BY: CEB

FOR RETTEW ASSOCIATES BY:

NO.	DATE	REVISION

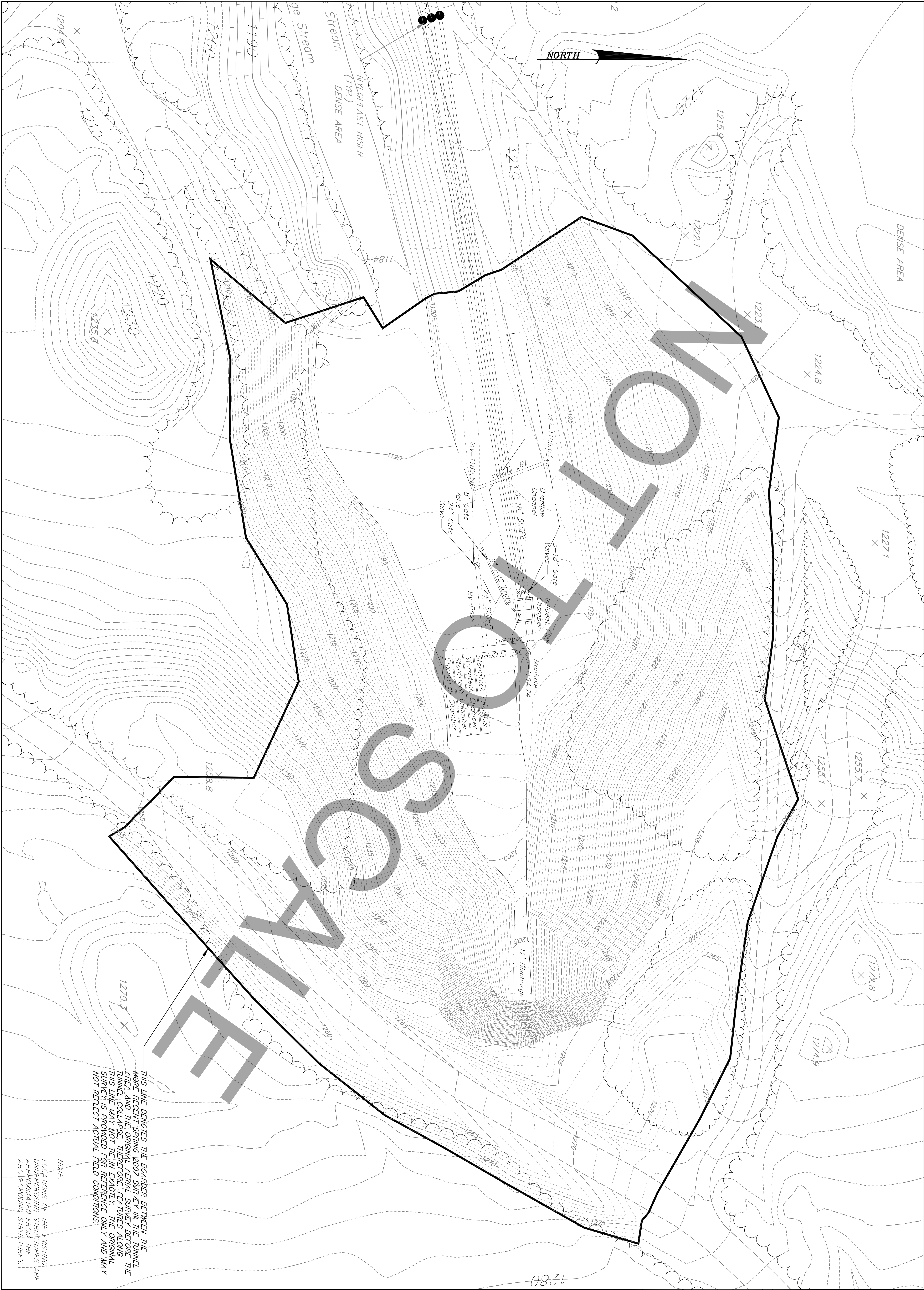

ISSUED FOR BIDDING	SHEET NO. 3 OF 11	DATE: JUNE 29, 2007	FLOOD DAMAGE REPAIRS		<div>RETTEW</div> <div>RETTEW Associates, Inc. 950 E. Main Street, Suite #220 Schuylkill Haven, PA 17972 Phone (570) 385-2270 • Fax (570) 385-2217 Email: rettew@rettew.com Website: www.rettew.com</div> <div>Engineers • Planners • Surveyors • Landscape Architects Environmental Consultants</div>	CLIENT <div>SCHUYLKILL CONSERVATION DISTRICT 1206 AG CENTER DRIVE POTTSVILLE, PA 17901-9733</div> <div><div>SCALE</div><div>0' 10' 20' 40' 60'</div><div>1" = 20'</div></div>	MANAGER: CLAYTON E. BUBECK, P.E.		SURV. CHIEF:	FIELDBOOK NO.	FOR RETTEW ASSOCIATES BY: <div><div>COMMONWEALTH OF PENNSYLVANIA</div><div>REGISTERED PROFESSIONAL</div><div>CHRISTINE HALDEMAN</div><div>ENGINEER</div><div>PE073813</div></div>																																																																																																																																																																																																																																																																																																																																																																																																																																																																																																																																																																																																																																																																																																																																																																																																																																																																																																																																																																																																																																																																																																																																																																																																																																																																																																																																																				
			DESIGN BY: CH				CHKD BY: CEB	DRAWN BY: CH/SBT	CHKD BY: CEB																																																																																																																																																																																																																																																																																																																																																																																																																																																																																																																																																																																																																																																																																																																																																																																																																																																																																																																																																																																																																																																																																																																																																																																																																																																																																																																																																						
			DRAWING REFERENCE: N:\06\06-03883-003\Cad\EE\06-03883-003-Existing.dwg																																																																																																																																																																																																																																																																																																																																																																																																																																																																																																																																																																																																																																																																																																																																																																																																																																																																																																																																																																																																																																																																																																																																																																																																																																																																																																																																																												
			XREFS:																																																																																																																																																																																																																																																																																																																																																																																																																																																																																																																																																																																																																																																																																																																																																																																																																																																																																																																																																																																																																																																																																																																																																																																																																																																																																																																																																												
			ABANDONED MINE DRAINAGE REMEDIATION PROJECT																																																																																																																																																																																																																																																																																																																																																																																																																																																																																																																																																																																																																																																																																																																																																																																																																																																																																																																																																																																																																																																																																																																																																																																																																																																																																																																																																												

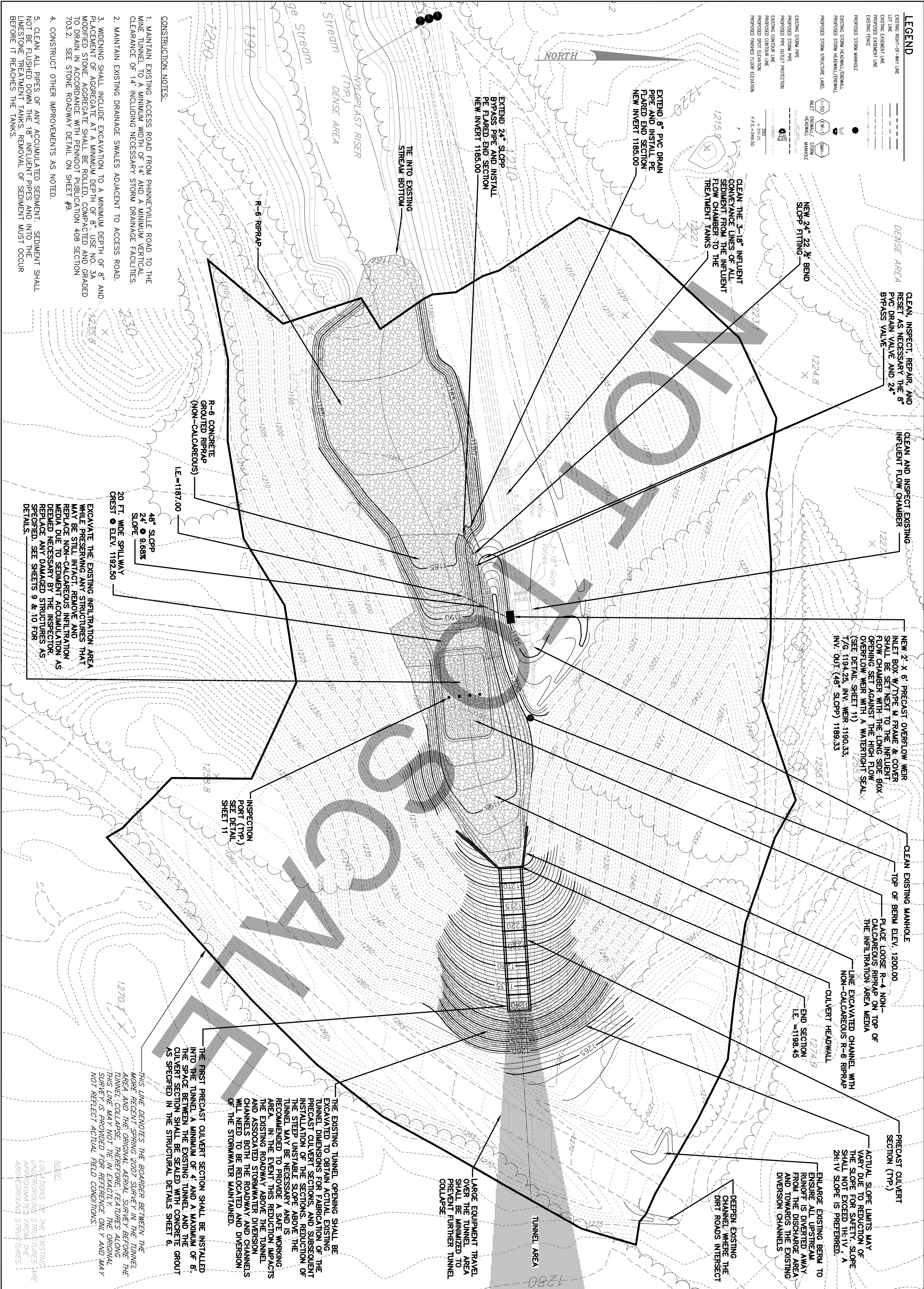

DATE: JUNE 29, 2007

SHEET NO. 4 OF 11

DWG. NO. 06-03883-003

FLOOD DAMAGE REPAIRS

FOR THE

AUDENREID MINE TUNNEL

ABANDONED MINE DRAINAGE REMEDIATION PROJECT

TUNNEL AREA REPAIR PLAN

EAST UNION TOWNSHIP

SCHUYLKILL COUNTY, PA

RETTEW Associates, Inc.

950 E. Main Street, Suite #220

Schuylkill Haven, PA 17972

Phone (570) 385-2270 • Fax (570) 385-2217

Email: rettew@rettew.com Website: www.rettew.com

Engineers • Planners • Surveyors • Landscape Architects

Environmental Consultants

CLIENT

SCHUYLKILL CONSERVATION DISTRICT

1206 AG CENTER DRIVE

POTTSVILLE, PA 17901-9733

SCALE

0' 10' 20' 40' 60'

1" = 20'

MANAGER: CLAYTON E. BUBECK, P.E.

DESIGN BY: CH

DRAWING REFERENCE: N:\06\06-03883-003\Cad\EE\06-03883-003-Proposed.dwg

XREFS:

SURV. CHIEF: FIELDBOOK NO. DATA COLLECTOR

CHKD BY: CEB

DRAWN BY: CH/SBT

CHKD BY: CEB

FOR RETTEW ASSOCIATES BY:

COMMONWEALTH OF PENNSYLVANIA

REGISTERED PROFESSIONAL ENGINEER

PE073813

CHRISTINE HALDEMAN

NO.

DATE

REVISION

LEGEND

- EXISTING RIGHT-OF-WAY LINE
- LOT LINE
- EXISTING EASEMENT LINE
- PROPOSED EASEMENT LINE
- EXISTING FENCE
- PROPOSED STORM MANHOLE
- EXISTING STORM HEADWALL/ENDWALL
- PROPOSED STORM HEADWALL/ENDWALL
- PROPOSED STORM STRUCTURE LABEL
- EXISTING STORM PIPE
- PROPOSED STORM PIPE
- PROPOSED PIPE OUTLET PROTECTION
- EXISTING CONDUIT LINE
- PROPOSED CONDUIT LINE
- PROPOSED SPOT ELEVATION
- PROPOSED FINISHED FLOOR ELEVATION

FF.E.=348.50

CLEAN, INSPECT, REPAIR, AND RESET AS NECESSARY THE 8" PVC DRAIN VALVE AND 24" BYPASS VALVE

CLEAN AND INSPECT EXISTING INFLUENT FLOW CHAMBER

NEW 2' X 6' PRECAST OVERFLOW WEIR INLET BOX W/DPE M FRAME & COVER SHALL BE SET NEXT TO THE INFLUENT FLOW CHAMBER WITH THE LONG SIDE BOX OPENING SET AGAINST THE HIGH FLOW OVERFLOW WEIR WITH A WATERTIGHT SEAL (SEE DETAIL SHEET 11)
1/6, 1194.25, INV. WEIR 1180.33, INV. OUT (48" SLOPE) 1189.33

CLEAN EXISTING MANHOLE TOP OF BERM ELEV. 1200.00

PLACE LOOSE R-4 NON-CALCAREOUS RIPRAP ON TOP OF THE INFILTRATION AREA MEDIA

LINE EXCAVATED CHANNEL WITH NON-CALCAREOUS R-6 RIPRAP

CULVERT HEADWALL
END SECTION
I.E.=1198.45

PRECAST CULVERT SECTION (TYP.)

ACTUAL SLOPE LIMITS MAY VARY DUE TO REDUCTION OF THE SLOPE FOR SAFETY. SLOPE SHALL NOT EXCEED 1H:1V. A 2H:1V SLOPE IS PREFERRED.

ENLARGE EXISTING BERM TO ENSURE ALL UPTREAM RUNOFF IS DIVERTED AWAY FROM THE DISCHARGE AREA AND TOWARDS THE EXISTING DIVERSION CHANNELS

DEEPEN EXISTING CHANNEL WHERE THE DIRT ROADS INTERSECT

CLEAN THE 3-18" INFLUENT CONVEYANCE LINES OF ALL SEDIMENT FROM THE INFLUENT FLOW CHAMBER TO THE TREATMENT TANKS

EXTEND 8" PVC DRAIN PIPE AND INSTALL PE FLARED END SECTION
NEW INVERT 1185.00

EXTEND 24" SLOPP BYPASS PIPE AND INSTALL PE FLARED END SECTION
NEW INVERT 1185.00

THE INTO EXISTING STREAM BOTTOM

R-6 RIPRAP

R-6 CONCRETE GROUTED RIPRAP (NON-CALCAREOUS)

48" SLOPP
24" @ 9.68%
20 FT. WIDE SPILLWAY
CREST @ ELEV. 1192.50

INSPECTION PORT (TYP.)
SEE DETAIL SHEET 11

THE FIRST PRECAST CULVERT SECTION SHALL BE INSTALLED INTO THE TUNNEL A MINIMUM OF 4' AND A MAXIMUM OF 8'. THE SPACE BETWEEN THE EXISTING TUNNEL AND THE CULVERT SECTION SHALL BE SEALED WITH CONCRETE GROUT AS SPECIFIED IN THE STRUCTURAL DETAILS SHEET 6.

THE EXISTING TUNNEL OPENING SHALL BE EXCAVATED TO OBTAIN ACTUAL EXISTING TUNNEL DIMENSIONS FOR FABRICATION OF THE PRECAST CULVERT SECTIONS, AND SUBSEQUENT INSTALLATION OF THE SECTIONS. REDUCTION OF THE STEEP UNSTABLE SLOPE ABOVE THE TUNNEL MAY BE NECESSARY AND IS RECOMMENDED TO PROVIDE A SAFE WORKING AREA. IN THE EVENT THIS REDUCTION IMPACTS THE EXISTING ROADWAY ABOVE THE TUNNEL AND ASSOCIATED STORMWATER DIVERSION CHANNELS BOTH THE ROADWAY AND CHANNELS WILL NEED TO BE RELOCATED AND DIVERSION OF THE STORMWATER MAINTAINED.

LARGE EQUIPMENT TRAVEL OVER THE TUNNEL AREA SHALL BE MINIMIZED TO PREVENT FURTHER TUNNEL COLLAPSE.

THIS LINE DENOTES THE BOARDER BETWEEN THE MORE RECENT SPRING 2007 SURVEY IN THE TUNNEL AREA AND THE ORIGINAL AERIAL SURVEY BEFORE THE TUNNEL COLLAPSE. THEREFORE, FEATURES ALONG THIS LINE MAY NOT BE IN EXACTLY THE ORIGINAL SURVEY IS PROVIDED FOR REFERENCE ONLY AND MAY NOT REFLECT ACTUAL FIELD CONDITIONS.

NOTES:
LOCATIONS OF THE EXISTING UNDERGROUND STRUCTURES WERE APPROXIMATED FROM THE AERIAL SURVEY.

ISSUED FOR BIDDING

LEGEND

- EXISTING RIGHT-OF-WAY LINE
- LOT LINE
- EXISTING EASEMENT LINE
- PROPOSED EASEMENT LINE
- EXISTING FENCE
- PROPOSED STORM MANHOLE
- EXISTING STORM HEADWALL/ROWALL
- PROPOSED STORM HEADWALL/ROWALL
- PROPOSED STORM STRUCTURE LABEL
- EXISTING STORM PIPE
- PROPOSED STORM PIPE
- PROPOSED PIPE OUTLET PROTECTION
- EXISTING CONTOUR LINE
- PROPOSED CONTOUR LINE
- PROPOSED SPOT ELEVATION
- PROPOSED FINISHED FLOOR ELEVATION

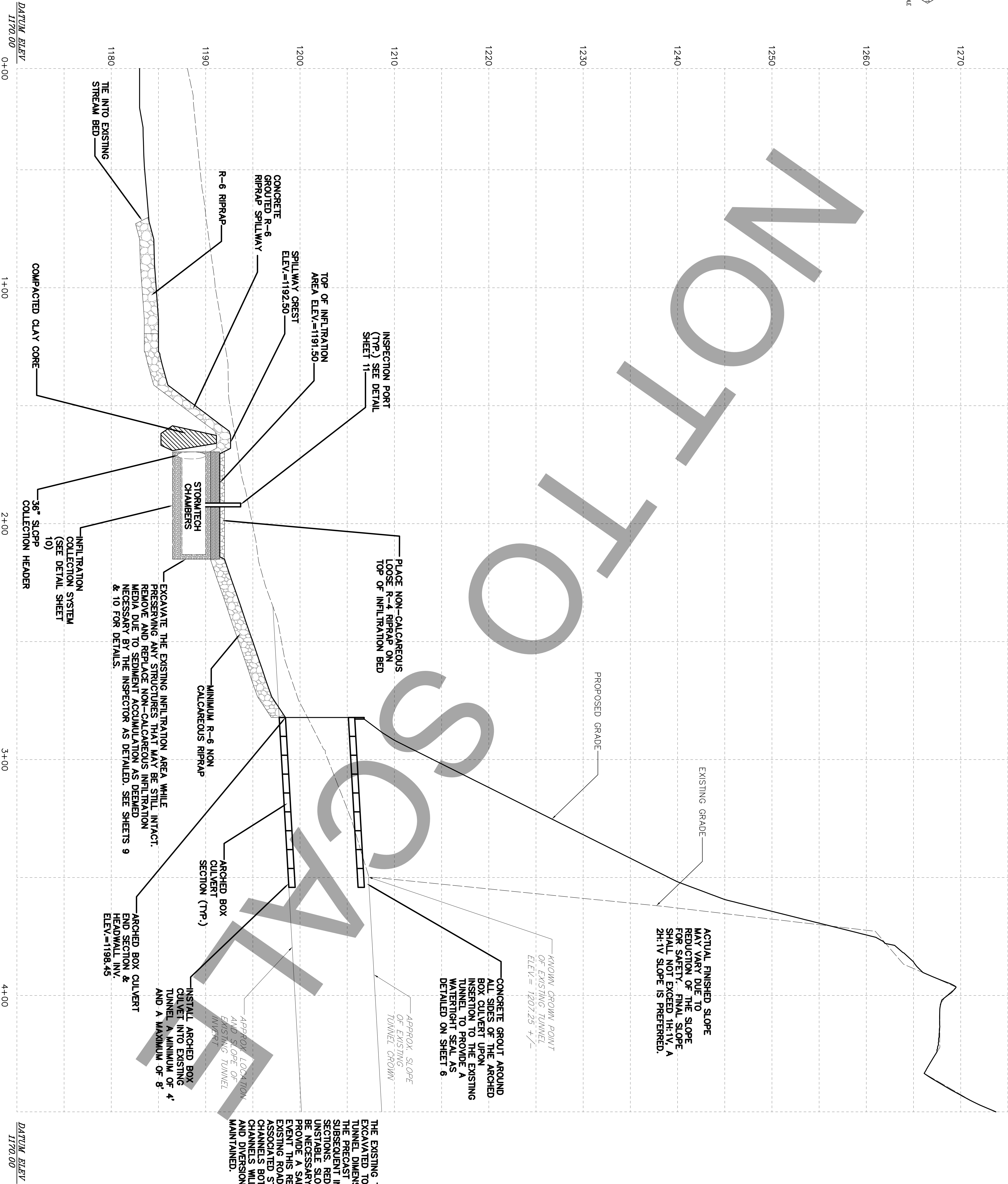

THE EXISTING TUNNEL OPENING SHALL BE EXCAVATED TO OBTAIN ACTUAL EXISTING TUNNEL DIMENSIONS FOR FABRICATION OF THE PRECAST CULVERT SECTIONS, AND SUBSEQUENT INSTALLATION OF THE SECTIONS. REDUCTION OF THE STEEP UNSTABLE SLOPE ABOVE THE TUNNEL MAY BE NECESSARY AND IS RECOMMENDED TO PROVIDE A SAFE WORKING AREA. IN THE EVENT THIS REDUCTION IMPACTS THE EXISTING ROADWAY ABOVE THE TUNNEL, ASSOCIATED STORMWATER DIVERSION CHANNELS BOTH THE ROADWAY AND CHANNELS WILL NEED TO BE RELOCATED AND DIVERSION OF THE STORMWATER MAINTAINED.

FLOOD DAMAGE REPAIRS
FOR THE
AUDENREID MINE TUNNEL
ABANDONED MINE DRAINAGE REMEDIATION PROJECT
TUNNEL AREA PROFILE
EAST UNION TOWNSHIP SCHUYLKILL COUNTY, PA

RETTEW
RETTEW Associates, Inc.
950 E. Main Street, Suite #220
Schuylkill Haven, PA 17972
Phone (570) 385-2270 · Fax (570) 385-2217
Email: rettew@rettew.com Website: www.rettew.com

Engineers · Planners · Surveyors · Landscape Architects
Environmental Consultants

CLIENT
SCHUYLKILL CONSERVATION DISTRICT
1206 AG CENTER DRIVE
POTTSVILLE, PA 17901-9733

SCALE
0' 10' 20' 40' 60'

MANAGER: CLAYTON E. BUBECK, P.E.
DESIGN BY: CH
CHKD BY: CEB
DRAWING REFERENCE:
N:\06\06-03883-003\Cad\EE\06-03883-003-Proposed.dwg
XREFS:

SURV. CHIEF: CH
DRAWN BY: CH/SBT
CHKD BY: CEB

FIELDBOOK NO. DATA COLLECTOR
CHKD BY: CEB

FOR RETTEW ASSOCIATES BY:

CHRISTINE HALDEAN
ENGINEER
PE073813

NO.	DATE	REVISION

DATE: JUNE 29, 2007
SHEET NO. 5 OF 11
DWG. NO. 06-03883-003
ISSUED FOR BIDDING

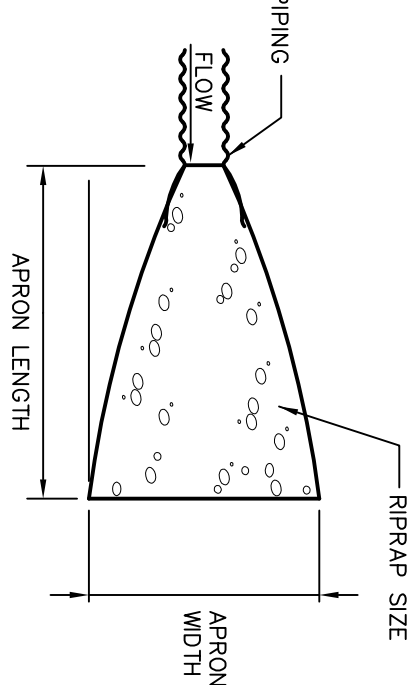

PLAN

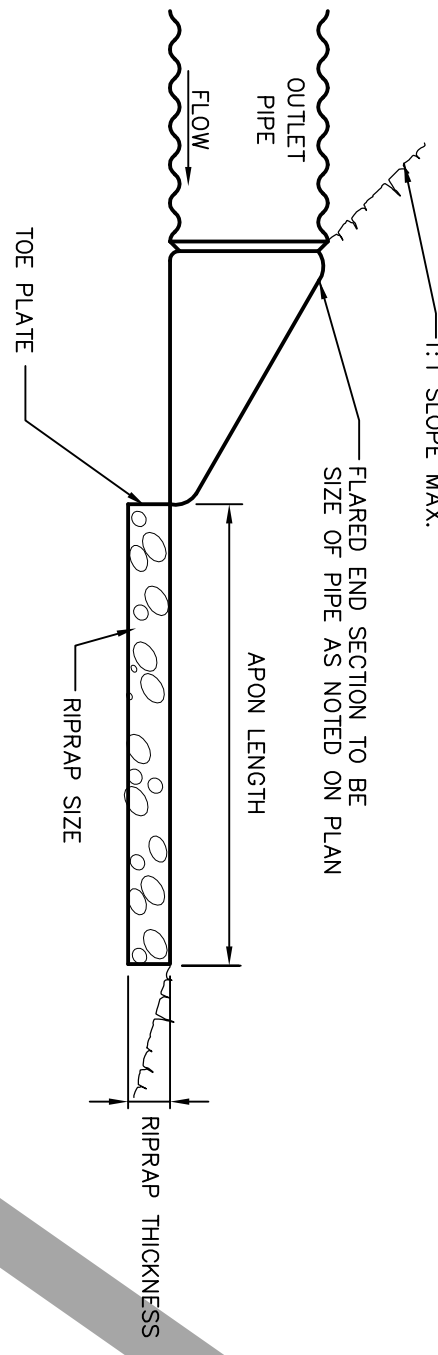

CROSS-SECTION

OUTLET	APRON LENGTH	APRON WIDTH	RIPPRAP SIZE	RIPPRAP THICKNESS
8" DRAIN PIPE	6'	2'-6"	R-6	30"
24" BYPASS PIPE	20'	26'	R-6	30"

- NOTES:
1. MERGE END SECTION INTO RIPRAPPED SPILLWAYS WHERE REQUIRED.
 2. SHOULD REQUIRED SPILLWAY RIPRAP SIZE EXCEED REQUIRED OUTLET PROTECTION RIPRAP USE THE REQUIRED SPILLWAY RIPRAP.

FLARED END SECTION OUTLET PROTECTION

NOT TO SCALE

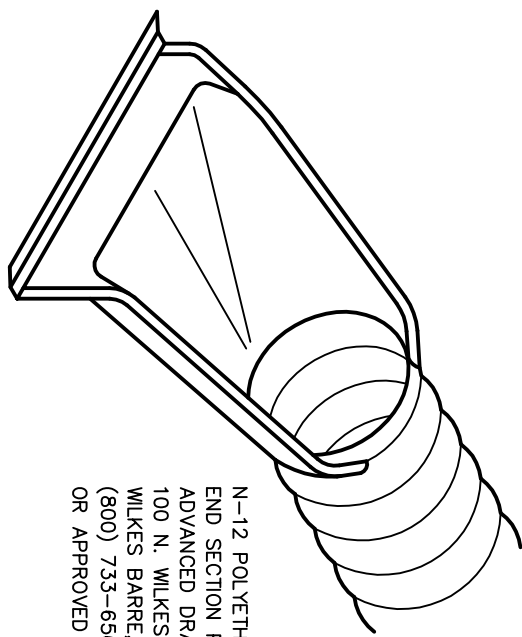

ISOMETRIC

N-12 POLYETHYLENE FLARED END SECTION, 18" DIA. 100' N. WILKES BARRE, PA. 18702
WILKES BARRE, PA. 18702
OR APPROVED EQUIVALENT

POLYETHYLENE FLARED END SECTION

NOT TO SCALE

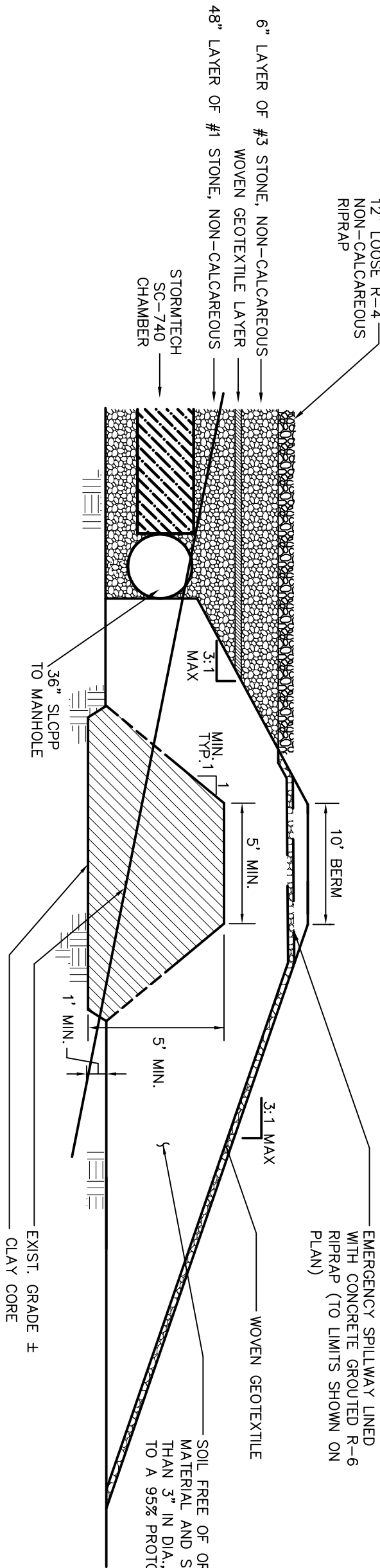

- NOTE:
- CLAY CORE SHALL BE KEPT INTO AND THREE FEET OF THE EXISTING CHANNEL. THE CLAY USED IN THE CHANNEL SHALL CONSIST OF CLAY CONTAINING NO MORE THAN 15% (BY VOLUME) STONE NO LARGER THAN TWO (2) INCHES IN DIAMETER. CLAY SHALL BE PLACED IN SIX (6) INCH LIFTS AND COMPACTED BY A HANDS BATTEN TO A MINIMUM 95% OF MAXIMUM DENSITY AT OPTIMUM MOISTURE CONTENT.

SECTION

INFILTRATION COLLECTION SYSTEM BERM

NOT TO SCALE

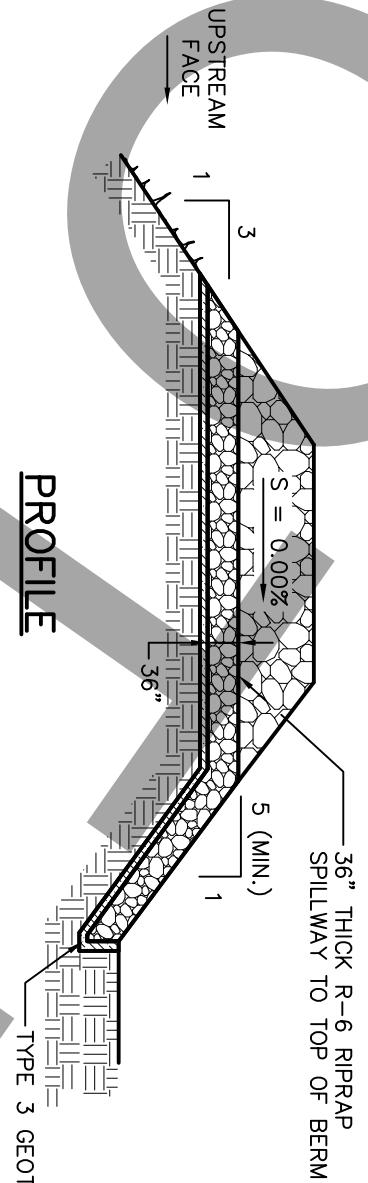

PROFILE

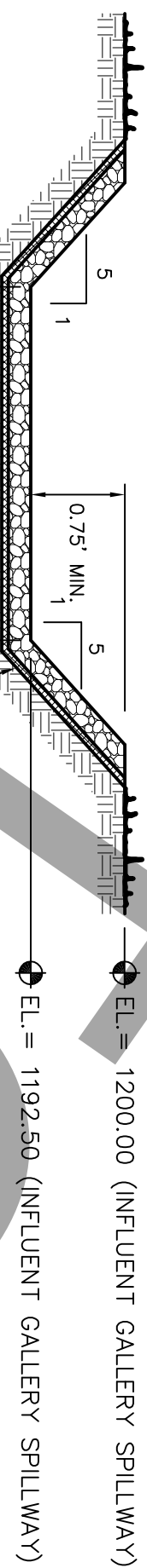

SECTION

EMERGENCY SPILLWAY

NOT TO SCALE

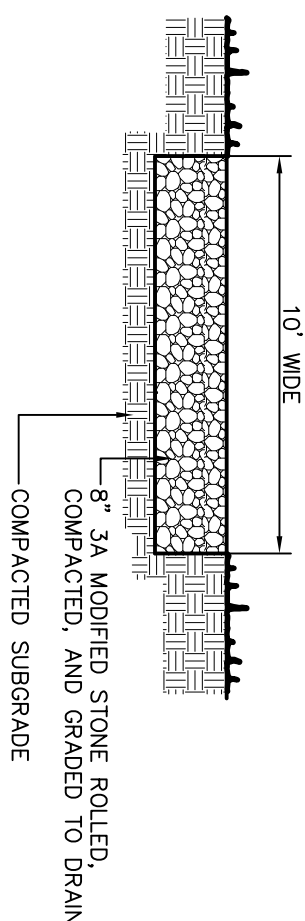

STONE ROADWAY SECTION

NOT TO SCALE

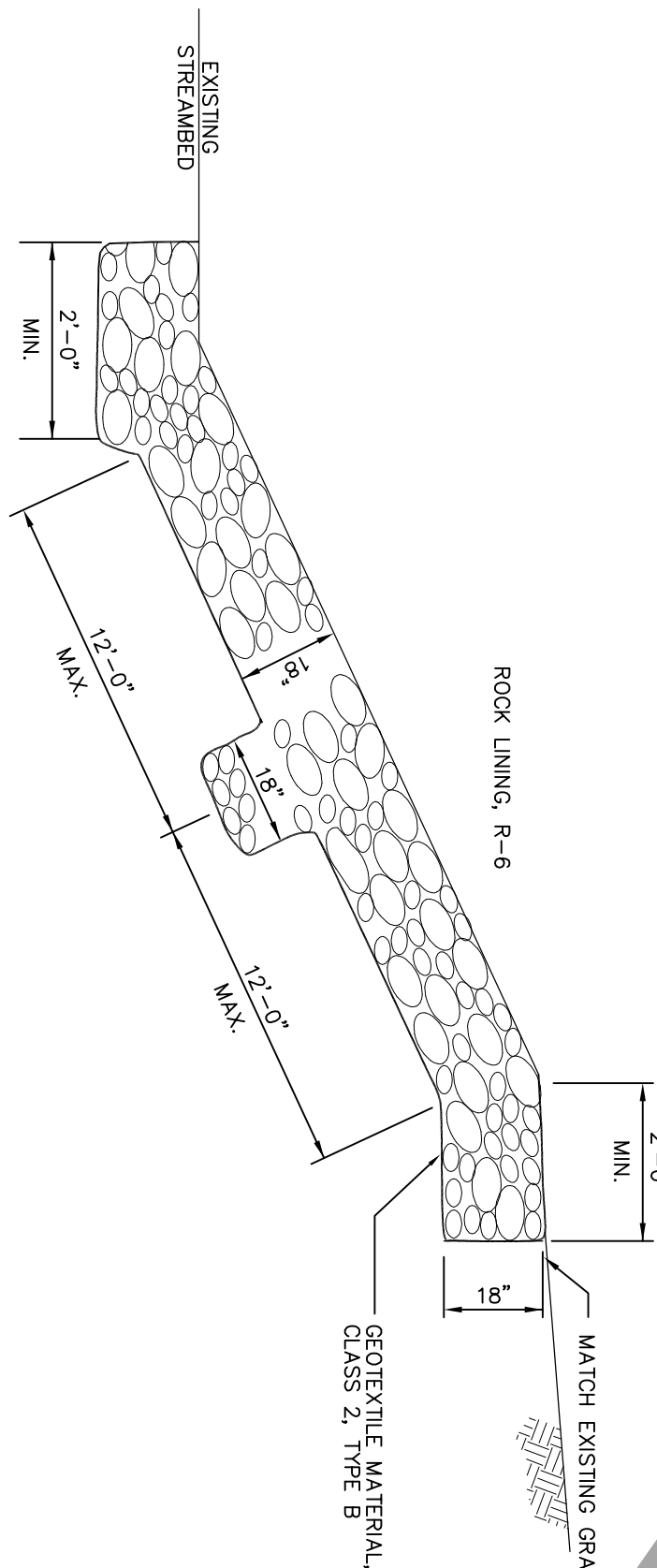

RIPPRAP STREAMBANK STABILIZATION

NOT TO SCALE

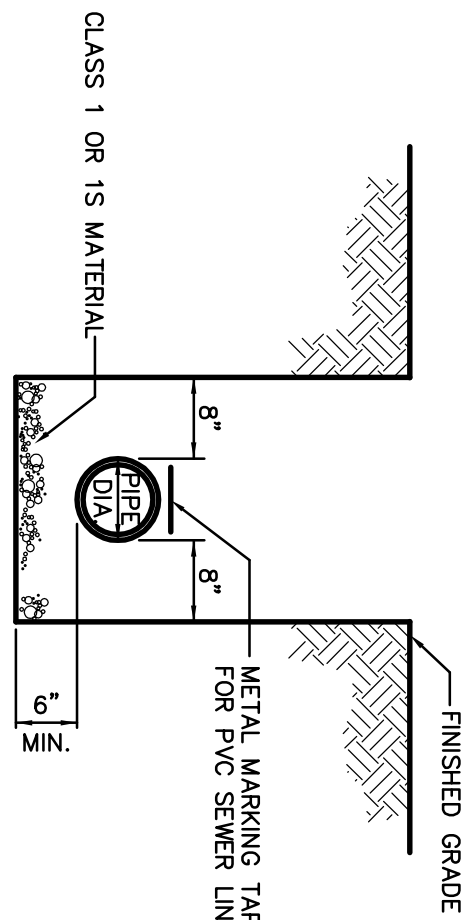

TYPICAL TRENCH DETAIL

NO SCALE

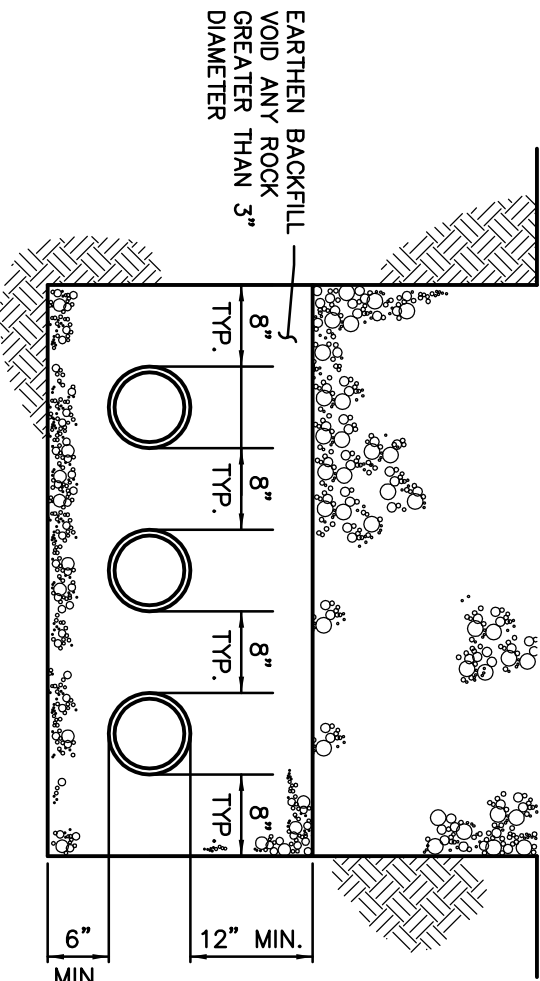

- NOTE:
- THIS DETAIL APPLIES TO TRENCHES CONTAINING ONE, TWO, OR THREE PIPES.

BACKFILL DETAIL FOR INTAKE AND OUTFALL PIPES

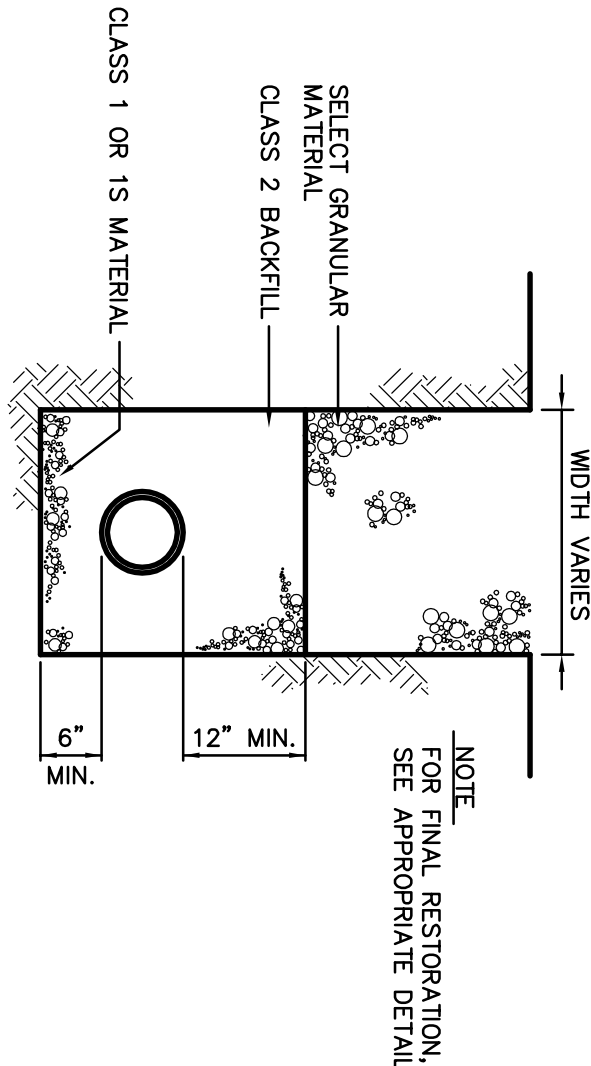

TYPICAL BACKFILL (NON-PAVED AREAS)

NO SCALE

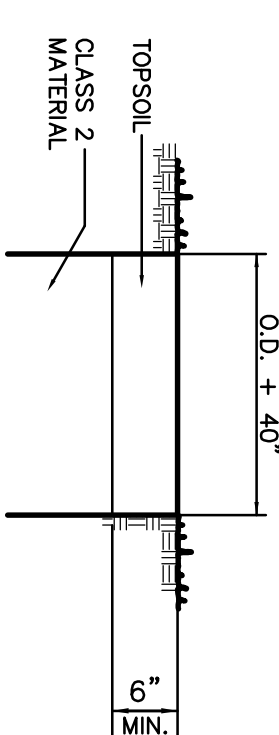

LAWN/FIELD RESTORATION

NO SCALE

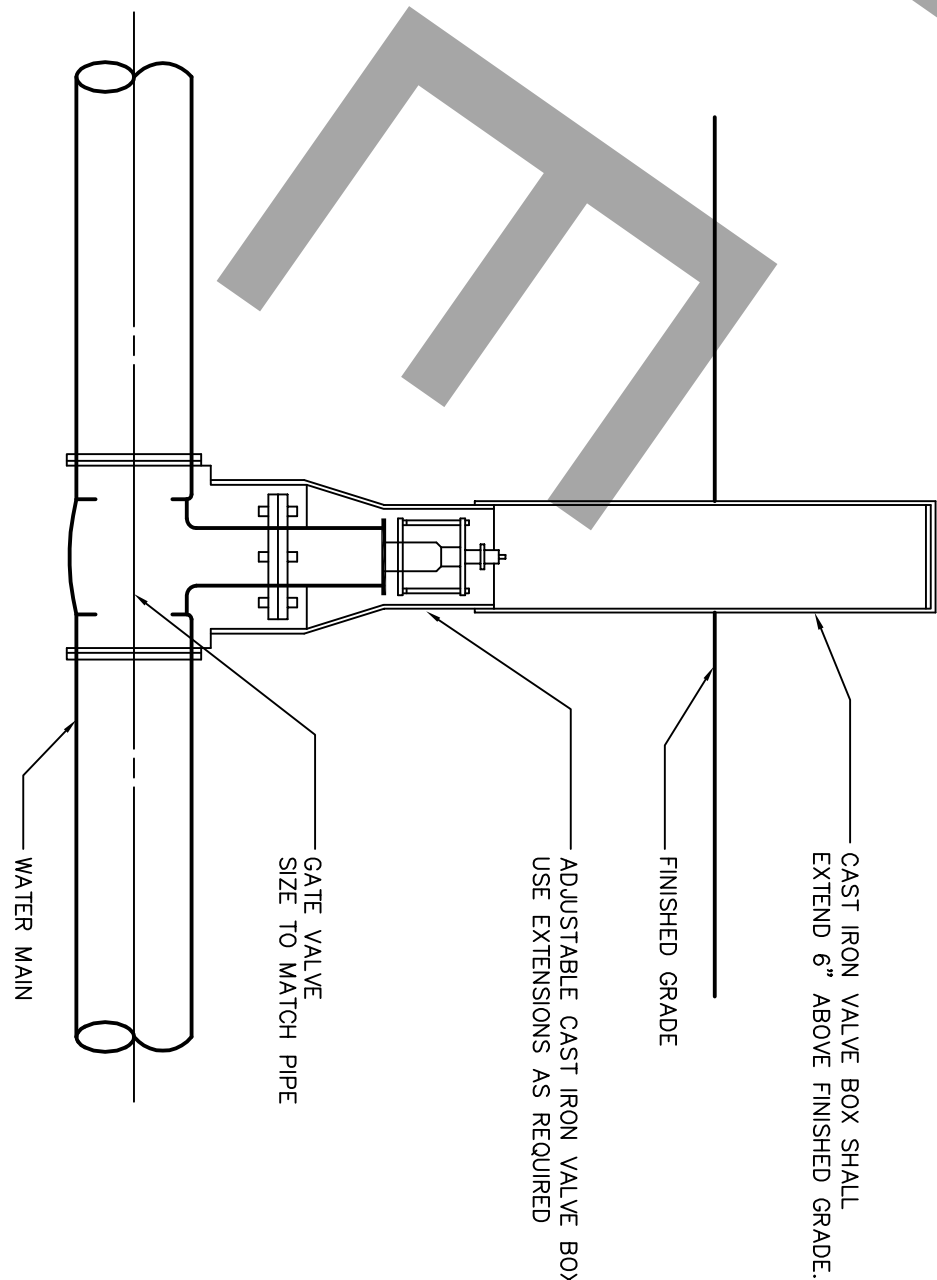

TYPICAL GATE VALVE & VALVE BOX DETAIL

DETAIL SUPPLIED FOR REFERENCE SHOULD VALVE RESETTING BE NECESSARY.

NO.	DATE	REVISION



MANAGER: CLAYTON E. BUBECK, P.E.	SURV. CHIEF:	FIELDBOOK NO. DATA COLLECTOR
DESIGN BY: CH	CHKD BY: CEB	CHKD BY: CEB
DRAWING REFERENCE: N:\06\06-03883-003\Cad\EE\06-03883-003-Details.dwg	DRAWN BY: CH/SBT	
XREFS:		

CLIENT	SCALE NO SCALE
SCHUYLKILL CONSERVATION DISTRICT 1206 AG CENTER DRIVE POTTSVILLE, PA 17901-9733	

RETTEW
 RETTEW Associates, Inc.
 950 E. Main Street, Suite #220
 Schuylkill Haven, PA 17972
 Phone (570) 385-2270 • Fax (570) 385-2217
 Email: rettetw@rettetw.com Website: www.rettetw.com
 Engineers • Planners • Surveyors • Landscape Architects
 Environmental Consultants

FLOOD DAMAGE REPAIRS FOR THE AUDENREID MINE TUNNEL ABANDONED MINE DRAINAGE REMEDIATION PROJECT	EAST UNION TOWNSHIP SCHUYLKILL COUNTY, PA
DATE: JUNE 29, 2007	
SHEET NO. 9 OF 11	
DWG. NO. 06-03883-003	

ISSUED FOR BIDDING

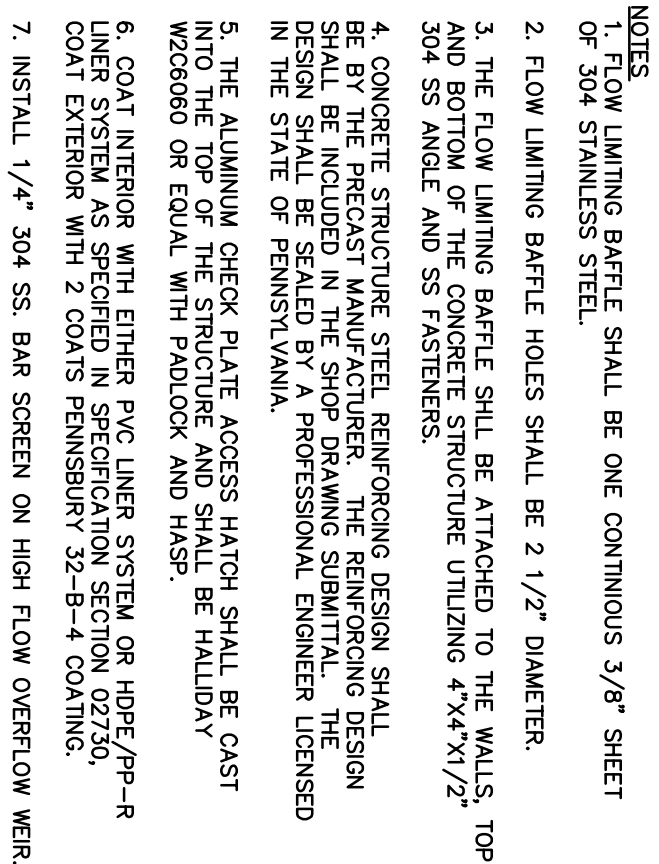

INFLUENT FLOW CHAMBER DETAIL

NOT TO SCALE - ALL DIMENSIONS IN FEET

THIS DETAIL PROVIDED FOR REFERENCE ONLY. STRUCTURE SHOULD BE INTACT AS DEPICTED
NOTIFY INSPECTOR IF NOT AS DEPICTED. CLEAN STRUCTURE OF ANY ACCUMULATED
SEDIMENT.

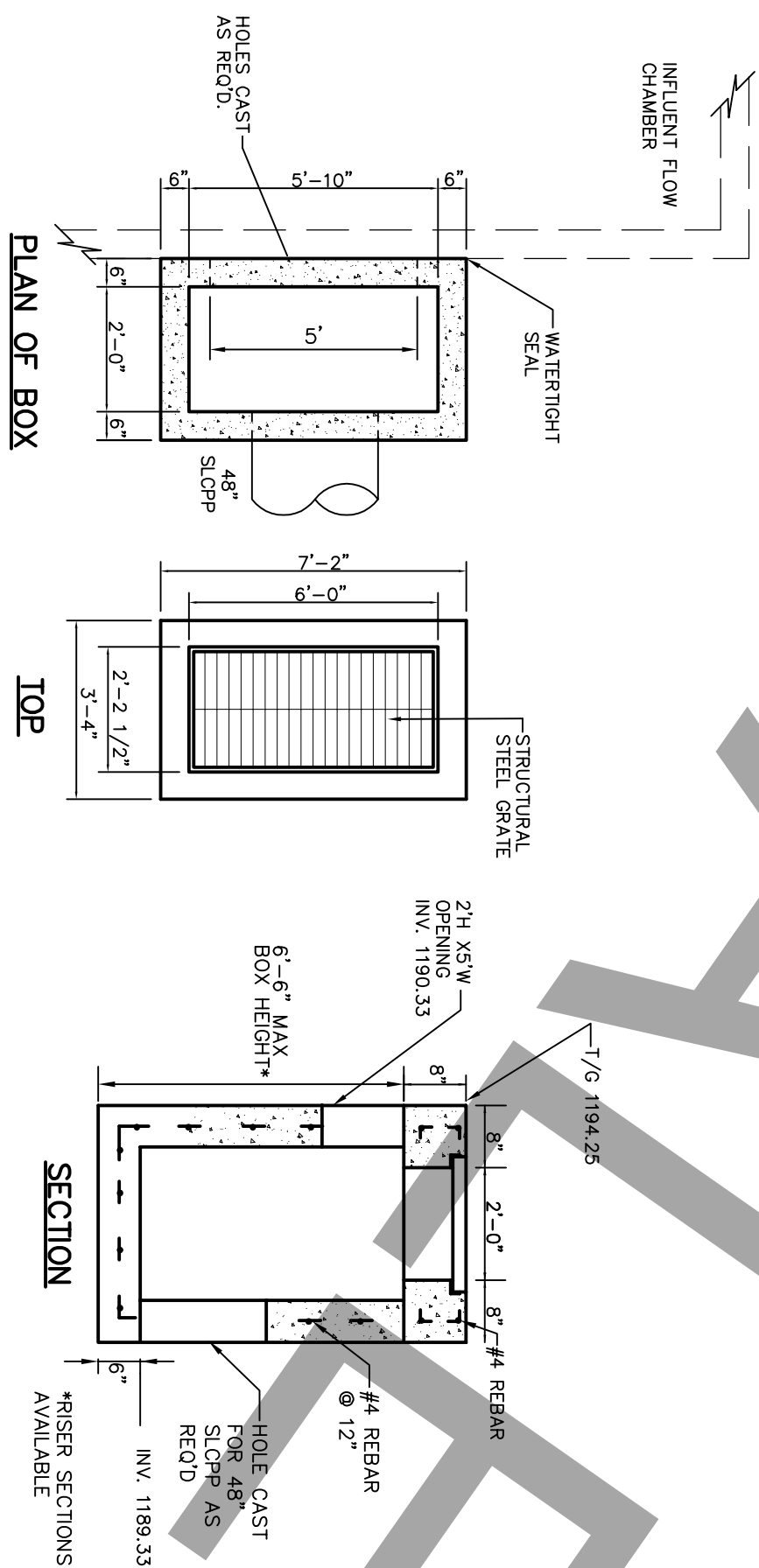
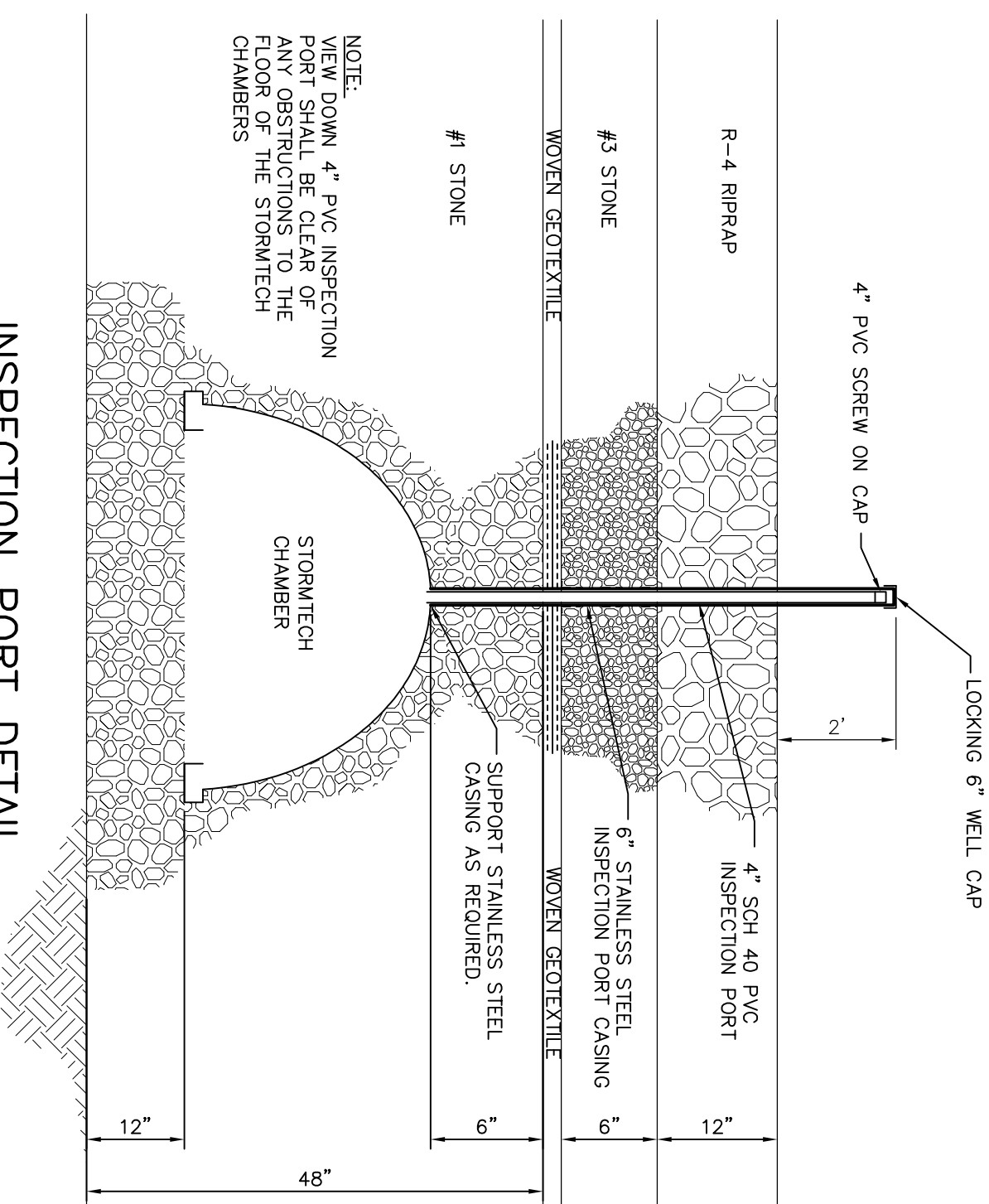

2' X 6' OVERFLOW WEIR BOX

NOI 10 SCALE
SD\SD016

NO.	DATE	REVISION

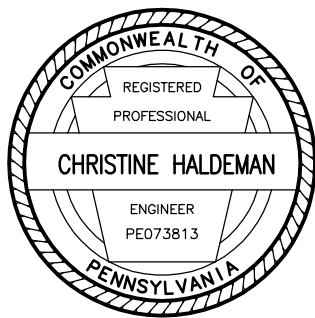

FOR RETTEW ASSOCIATES BY:

FIELDBOOK NO

CHKD BY:
CFB

OLD

SURV. CHIEF:

DRAWN BY:
CH / SBT

011/SD1

CHKD BY:
CFB

REFERENCE:

MANAGER:

DESIGN BY:
CH

OFF
DRAWING REF

XREFS:

CLIENT

SCHUYLKILL CONSERVATION DISTRICT
1206 AG CENTER DRIVE
POTTSVILLE, PA 17901-9733

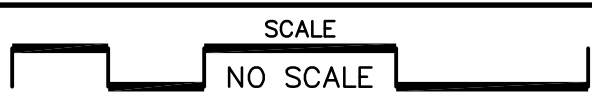

RETTEW

RETTEW Associates, Inc.
950 E. Main Street, Suite #220
Schuylkill Haven, PA 17972
Phone (570) 385-2270 • Fax (570) 385-2217
Email: rettew@rettew.com Website: www.rettew.com

Engineers • Planners • Surveyors • Landscape Architects
Environmental Consultants

FLOOD DAMAGE REPAIRS
FOR THE
AUDENREID MINE TUNNEL
ABANDONED MINE DRAINAGE REMEDIATION PROJECT
DETAILS SHEET

EAST UNION TOWNSHIP SCHUYLKILL COUNTY, PA

DATE: JUNE 29, 2007

SHEET NO. 11 OF 11

WG. NO. 06-03883-003

ISSUED FOR BIDDING